

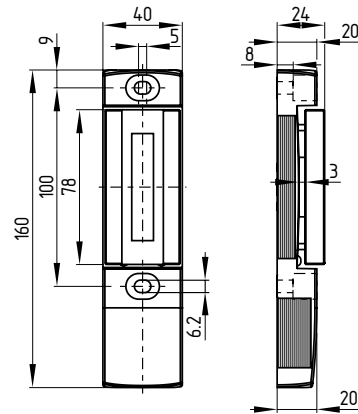

DE Operating instructions. . . . . Page 1  
Original

**Dimensions**

All measurements in mm.



**Axial misalignment and operating direction of the latching force**

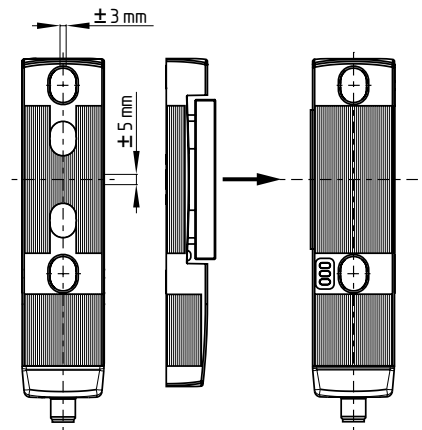

! The safety component must be operated in the operating direction of the latching force (refer to image).

**General mounting instructions**

! Please observe the relevant requirements of the standards ISO 12100, ISO 14119 and ISO 14120.

For fitting the solenoid interlock and the actuator, two mounting holes for M6 screws with washers (washers included in delivery) are provided (Tightening torque: 8 N).

! The solenoid interlock must be used as an end stop.

Any mounting position. The system must only be operated with an angle of  $\leq 2^\circ$  between the solenoid interlock and the actuator. After fitting, the mounting holes can be sealed by means of the supplied plugs. The plugs serve as a means of sealing the assembly openings and are also suitable to prevent against tampering with the screw connection.

! The actuator must be permanently fitted to the safety guards and protected against displacement by suitable measures (e.g. tamperproof screws, gluing, drilling of the screw heads).

**K. A. Schmersal GmbH & Co. KG**  
Möddinghofe 30, D - 42279 Wuppertal  
Postfach 24 02 63, D - 42232 Wuppertal

Phone: +49 - (0)2 02 - 64 74 - 0  
Telefax: +49 - (0)2 02 - 64 74 - 1 00  
E-Mail: info@schmersal.com  
Internet: http://www.schmersal.com

