

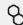



## LED Indicators

 Power supply	<ul style="list-style-type: none"> <li>• Blue – mains power</li> <li>• Red – HW error</li> <li>• Green – battery power</li> <li>• Yellow – battery removal required, two-year life exceeded</li> <li>• Yellow flashing once in 1 s (0.5 s / 0.5 s) – battery error</li> <li>• No light – device off</li> </ul> <p><b>If an HW error is indicated by the red LED, request a remedy or compensation from your distributor.</b></p>
 Network	<ul style="list-style-type: none"> <li>• Blue – primary SIM card used</li> <li>• Yellow – secondary SIM card used</li> </ul> <p>Function:</p> <ul style="list-style-type: none"> <li>• Light on – connected to the network</li> <li>• Flashing once in 1 s – disconnected from the network, SIM card detected</li> <li>• Flashing once in 3 s – disconnected from the network, no response from SIM card</li> </ul>
 Line	<ul style="list-style-type: none"> <li>• Blue – SIP call</li> <li>• Green – VoLTE call</li> <li>• Yellow – call via a mobile voice channel</li> </ul> <p>Function:</p> <ul style="list-style-type: none"> <li>• No light – onhook</li> <li>• Flashing once in 1 s – onhook, dialing / incoming call (ringing) in progress</li> <li>• Light on – active call</li> </ul>
 Data	<ul style="list-style-type: none"> <li>• Blue – connected to the 4G network</li> <li>• Green – connected to the 3G network</li> <li>• Yellow – connected to the 2G network</li> </ul> <p>Function:</p> <ul style="list-style-type: none"> <li>• Flashing once in 3 s – Internet connection in progress (criteria – connection to My2N)</li> <li>• Flashing once in 1 s – SIP Proxy connection in progress</li> <li>• Light on – connected</li> </ul>
 Signal	Signaling of the 2G, 3G or 4G signal strength.

2N TELEKOMUNIKACE a.s. hereby declares that the 2N® EasyGate IP product is in compliance with the 2014/53/EU and 2011/65/EU directives. Refer to [www.2n.cz](http://www.2n.cz) for the full wording of the EU declaration of conformity.



# 2N® EasyGate IP Quick Guide

## Product Introduction

2N® EasyGate IP is designed primarily for voice transmission over VoIP (or VoLTE, GSM, UMTS) between a mobile network and a connected FXO-equipped terminal (PBX, phone, lift communicator, answering machine, etc.). When connected to the 2N® Elevator Center cloud service, the gateway's functionality is extended to include remote management, auto provisioning, real-time device state monitoring and others.



## Basic Functions

- Calls (VoIP, VoLTE, CS call)
- Data transmission
- SMS sending
- Autonomous battery operation
- Remote management (2N® Elevator Center)
  - automatic configuration
  - bulk upgrade
  - remote access
  - real-time device state monitoring



The 2N® EasyGate IP package includes the following:

2N® Easy Gate IP	1 pc
DIN rail holder	1 pc
Dowels (6 mm) with screws (4.5 x 40 mm)	2 + 2 pcs
Screw for fitting the device in the holder	1pc
Antenna	1 pc
FXS cable	1 pc
Power supply	1 pc
Quick guide	1 pc
NiMH type AA, 1.2 V / 2000 mAh battery	4 pcs

## Connector Layout and Meanings



FXS	Analog line
RELAY	NO (Normally Open), contact that is open against the COM contact at relax. COM, contact that switches between NO and NC after voltage is applied to the coil. NC (Normally Closed), contact that is connected with the COM contact at relax.
INPUT	Short-circuit input. Not used for voltage connection.
RS232	Used for connecting the device with the serial bus (in some controller types, e.g.). TX, transmission wire interface. RX, receiving wire. GND, grounding.
RESET	A short press restarts the device. A long press (10 s) resets the device factory values.
USB	Used for local access to the 2N® EasyGate IP settings via a Web configuration utility.
SIM 1	Primary SIM card slot without PIN.
SMA	Antenna connector.
SIM 2	Secondary SIM card slot for primary SIM card backup in the case of signal loss.
POWER	Power supply connector.
EXT BATT	Connector for remote connection of 4 NiMH batteries outside the device. Make sure that the internal batteries are removed before connecting external batteries.
O/I	Device on/off switch.

## Mechanical Installation

2N® EasyGate IP is designed for indoor mounting on a vertical surface using a DIN rail holder or on a wall using screws fitted to the holder mounting holes. The installed device is intended for permanent operation at the minimum separation distance of 20 cm from the user.

### Wall mounting

Use the holder and two dowels with screws included in the package to install 2N® EasyGate IP on a wall. Drill holes in a selected place and selected height of the wall and insert the dowels. Pass the screws through the holder holes and screw them into the dowels in the wall. Now all you have to do is slide 2N® EasyGate IP from the top into the holder profile.

2

## DIN rail mounting

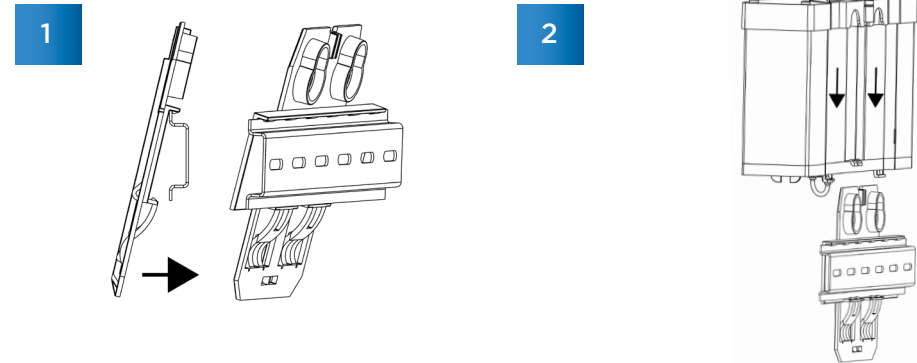

No other tool is needed for DIN rail installation. The DIN rail holder has a standard size of 35 mm. Put the upper inner side of the holder profile on the DIN rail and push its bottom side to make the holder click and fit to the DIN rail. Now all you have to do is slide 2N® EasyGate IP from the top into the DIN rail holder profile. Now all you have to do is insert 2N® EasyGate IP in the holder profile from the top downwards and fit the gateway position with a screw.



!!! Only vertical mounting with the connectors heading down guarantees that the device will be waterproof. If installed otherwise, the device may be infiltrated with water and damaged irreversibly !!!

With the supplied batteries, the device may be operated in the range of 0 °C - 45 °C. Outside this range, the device may not be operated with the supplied batteries. Remember to use batteries with increased thermal resistance in order to make the backup function work. You can connect an external battery with increased thermal resistance or use an external battery placed under convenient temperature conditions.

## Putting in Operation

### Device Connection to Power

Connect the included power supply terminal block into the dedicated Power connector and connect the power supply to the electrical mains.

### Antenna Connection

Screw the enclosed antenna into the SMA antenna connector. Tighten the antenna connector gently with your hand, never use a wrench!

### SIM Card Installation

Insert a SIM card without PIN request into the SIM 1 slot on the device bottom side. Remember to set PIN deactivation and such provider services as call forwarding, call barring, preferred networks, SMS center, etc., in your mobile phone, for example, before inserting the SIM card in 2N® EasyGate IP.

2N® Elevator Center, a licensed cloud service, is used for remote management of 2N® EasyGate IP. Ask your distributor to create the service access data for you. Refer to 2n.cz for details on the 2N® Elevator Center service.

To configure 2N® EasyGate IP without the 2N® Elevator Center cloud service connect the device to a PC via a USB cable and use 2N® EasyGate IP – Web configuration utility, which can be downloaded for free from 2n.cz. The 2N® Easygate IP local connection tool also includes a manual that described the tool installation and leads the user as far as the web interface login page. Enter **Admin** as the user name and **2n** as the password for the first login. Having been logged in to the web interface, you will be invited to change the default password.

Refer to the 2N® EasyGate IP full manual at [wiki.2n.cz](http://wiki.2n.cz) for device configuration details.

3