



EN Operating instructions.pages 1 to 2
Original

The normal locking function is not restored until the triangular key has been turned 90° back to its original position.



Do not turn triangular key beyond end stop.

Locked

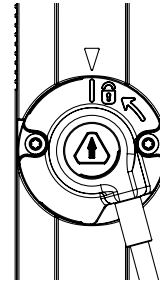

Unlocked

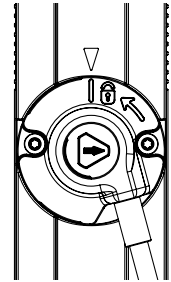

Triangular key, 101100887, available as an accessory.

Dimensions

All measurements in mm.

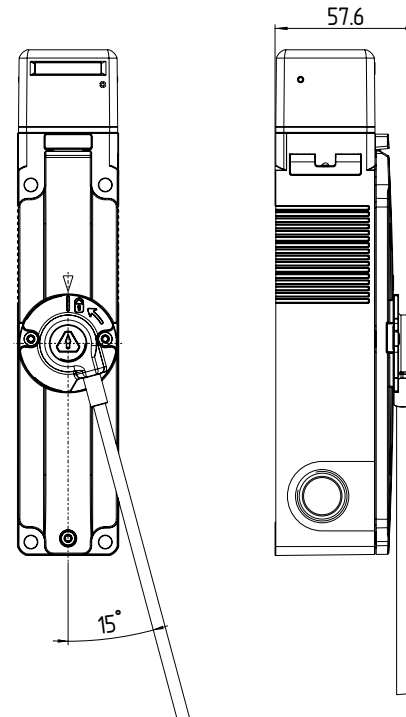

About this document

These operating instructions serve as a supplement to the operating instructions for AZM150. Deviating or additional instructions follow.

Purpose

The Bowden cable release is an accessory that can be used in connection with the solenoid interlock AZM150.

The Bowden cable release facilitates remote release via a pull cable. If deployed within the hazardous zone, the Bowden cable can be used as an emergency exit; if deployed outside a hazardous zone, it can be used as an emergency release (max. pull force 500 N, with use of the T-grip max. 250 N).



To make sure that the Bowden cable release functions correctly, the protective guard/safety door must not be in a mechanically stressed condition.



The function can only be assured if the pull cable is routed correctly and a suitable actuating element (handle, lever, etc.) is correctly attached. Both are the responsibility of the machine and plant construction engineer.

Assembly

Mounting Bowden cable

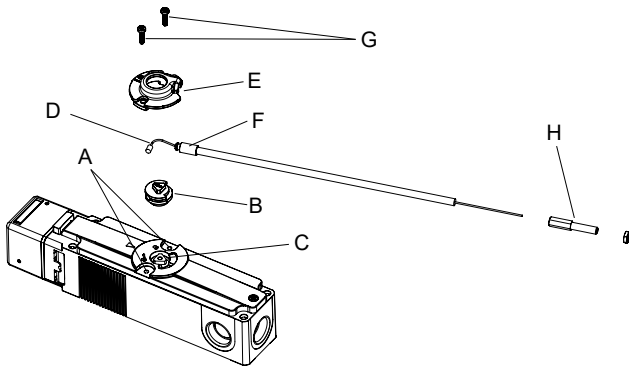

Key

- A: Holes for cover screws
- B: Adapter
- C: Manual release / triangular
- D: Cylinder nipple
- E: Adapter cover
- F: Hose fitting
- G: 2 x cover screws Torx 10
- H: M5 set screw with nut

1. Remove the protective sticker over the triangle C.
2. Loosen the two cover screws G and replace them with the enclosed screws (M3 x 13).

3. Fit adapter piece B, making sure that the triangle C and the adapter piece are in the correct position.

Attention: Alignment of the markings (arrows) on the cover and adapter piece triangle must point towards each other.

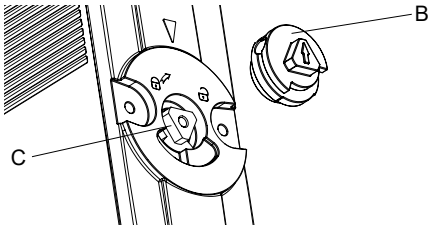

Fig.: Position of triangle and adapter

4. Insert the cylinder nipple D into the side hole of the adapter piece B and lay the wire rope in the groove of the adapter piece.

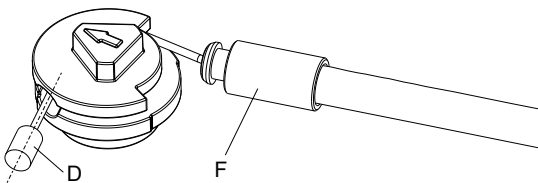

Fig.: Hose fitting with cylinder nipple

5. Put on the adapter cover E as shown (observe the following points):
 - Insert protruding surface of adapter cover in groove N of hose fitting F
 - Fasten the adapter cover with the cover screws G at position A of the AZM150 (tightening torque 0.5 Nm).

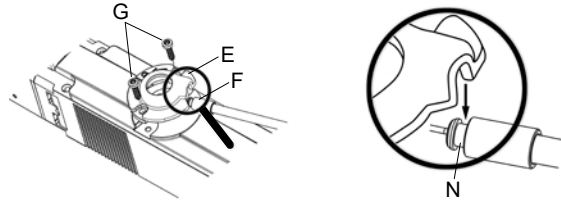

Fig.: Mounting adapter cover
(Detailed view of adapter cover on groove N of hose fitting)

6. Customer routing of the Bowden cable and attachment

7. Supplied M5 set screw H for attachment at end of hose (see fig. wall assembly)

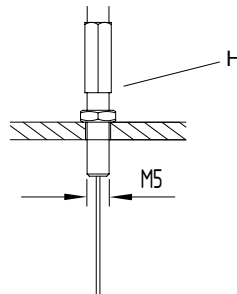

Fig.: Wall assembly

In addition to the information in the operating instructions for AZM150, observe the following:

- Following assembly, check function of Bowden cable.
- Minimum bend radius of cable is 100 mm. As a rule, the number of bends should be kept as low as possible.
- Check system for ease of movement.

Perform a visual and function check of the system at regular intervals.

Accessories (to be ordered separately):

T-grip (red) **ACC-AZM-BOW-H-1-RD** Ordering code 103027454

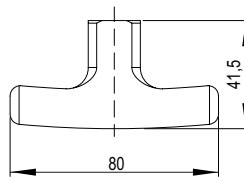

Fig.: T-grip

K.A. Schmersal GmbH & Co. KG
 Möddinghofe 30, 42279 Wuppertal
 Germany
 Phone: +49 202 6474-0
 Fax: +49 202 6474-100
 E-Mail: info@schmersal.com
 Internet: www.schmersal.com

Production site:
SCHMERSAL
Industrial Switchgear (Shanghai) Co., Ltd.
 Cao Ying Road 3336
 201712 Shanghai / Qingpu, P.R.CHINA
 Phone: +86-21-63 75 82 87
 Fax: +86-21-69 21 43 98
 E-Mail: info@schmersal.com.cn
 Internet: www.schmersal.com.cn

